

The following page(s) are extracted from multi-page Kuhnke product catalogues or CDRoms and any page number shown is relevant to the original document. The PDF sheets here may have been combined to provide technical information about the specific product(s) you have selected.

Hard copy product catalogues, and CDRoms have been published describing Kuhnke Pneumatics, Solenoids, Relays and Electronics; some divided into different books. A list of current publications is available on this web site or from our sales offices. Some may be available for download, but as substantially larger files.

## Contact Details

Kuhnke sales and service in the UK

H. Kuhnke Ltd  
Unit 21 Abbey Enterprise Center  
Premier Way  
Romsey  
SO51 9AQ

T: 01794 514445

F: 01794 513514

Email: [sales@kuhnke.co.uk](mailto:sales@kuhnke.co.uk)

### Important Note

The information shown in these documents is for guidance only. No liability is accepted for any errors or omissions. The designer or user is solely responsible for the safe and proper application of the parts, assemblies or equipment described.

---

# Logic Valves and Flow Controls

## Series 47

Kuhnke System Logic Devices

### AND/OR Logic Valves



**47002** AND Valve (Dual Pressure)

**47003** OR (Shuttle) Valve

**And** valve opens when pressure is present at both inlet ports. **Or** valve opens when pressure is present at either inlet port. Design uses piston construction, providing smooth output flow.

**Flow:** 200 l/m @ 8 bar

**Min. Op. Pressure:** 1 bar

**Through Body Mtg. Holes:**

3.4mm dia. on 17mm centers.

**Dimensions:** 24mm H x 25mm W x 12mm D.

**Ports:** M5

**Material:** Anodized Aluminum Housing

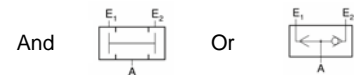

### Check Valve (Non Return)



**47260**

In line mounted, valve allows for flow in one direction only. Arrow on body shows direction of flow.

**Flow:** 225 l/m at 8 bar

**Operation:** Opens at 0.5 bar

**Dimensions:** 21.5mm L x 9mm Hex.

**Ports:** M5

**Material:** Brass



### Quick Exhaust Valve

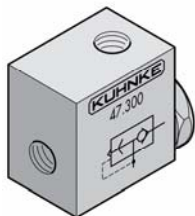

**47300**

In line mounted, outlet port exhausts directly to atmosphere at loss of inlet pressure.

**Dimensions:**

18mm H x 21mm W x 12.5mm D.

**Ports:** M5

**Material:** Brass



### Non Adjustable One Way Flow Control



**47251- \*\***

Mounts directly in port of valve or cylinder. Various fixed orifices reduce flow to a low and constant value. Check valve prevents flow in reverse direction.

Available with .10/.16/.25/.40/.60mm orifices. Add aperture size to catalogue number.

**Flow @ 7 bar:**

**\*\* .10** – 0.34 l/m

**\*\* .16** – 1.40 l/m

**\*\* .25** – 3.40 l/m

**\*\* .40** – 8.50 l/m

**\*\* .60** – 19.8 l/m

**Check Valve:** opens at 0.5 bar

**Dimensions:** 28mm H. x 8mm Hex.

**Ports:** M5

**Material:** Brass



## Adjustable Exhaust Flow Control

**47200**

**Flow full open:** 30 l/m @ 7 bar  
13 l/m @ 3 bar  
**Dimensions:** 14mm L x 8mm Hex.  
**Thread:** M5  
**Material:** Brass

For direct mounting on exhaust ports. Adjustable, equipped with locking nut to prevent tampering or loosening after setting is made.



## Adjustable Flow Control

Brass **47220**

Brass nickel plated **47220-01**

**Flow full open:** 55 l/m @ 7 bar  
24 l/m @ 3 bar  
**Dimensions:** 40.5mm H x 12mm Hex.  
**Ports:** M5  
**Material:** Brass

Needle valve type flow control for direct mounting or panel mounting through a 8.5mm dia. hole. Equipped with mounting nut. The knurled adjustment knob for fine adjustment has screw driver slot and shaft is equipped with locking nut to prevent tampering after proper setting is made.



## Adjustable One Way Flow Control

**47370**

**Flow full open:** 70 l/m @ 7 bar  
28 l/m @ 3 bar  
**Check Valve:** Opens at 0.5 bar  
**Dimensions:** 39mm H x 25mm W x 10mm D.  
**Through Body Mounting Holes:**  
4.3mm dia. on 18mm centers.  
**Housing:** Zinc alloy.  
**Ports:** M5

Finger adjustable via knurled knob equipped with screw slot. Has lock nut to lock adjustment. Can be mounted with screws through body or panel mounted through a 8.5mm dia. hole.

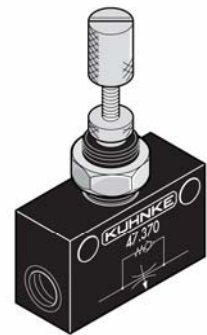

## Brass Adjustable One Way Flow Control

**47255**

**Flow full open:** 75 l/m @ 7 bar  
33 l/m @ 3 bar  
**Check Valve:** Opens at 0.5 bar.  
**Dimensions:** 47mm H x 20mm W x 10mm D.  
**Through Body Mounting Holes:**  
3.6mm dia. on 15mm centers.  
**Housing:** Brass  
**Ports:** M5

Finger adjustable via knurled knob equipped with screw slot. Has lock nut to lock adjustment. Can be mounted with screws through body or panel mounted through a 8.5mm dia. hole.

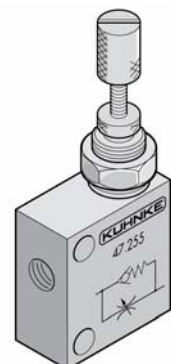

# Logic Valves and Flow Controls

## Series 47

Kuhnke System Logic Devices

### Push-In Fittings with One Way Adjustable Flow Controls

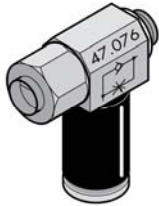

For Inlet Ports:

**47076** – 4x1 mm tubing, M5 thread

**47091** – 6x1mm tubing, G1/8 thread

For Exhaust Ports:

**47075** – 4x1 mm tubing, M5 thread

**47090** – 6x1mm tubing, G1/8 thread

For direct mounting on cylinder or valve ports, with L-banjo type instant push-in fitting and captive adjusting screw.

**Flow Full Open:**

M5 – 80 l/m @ 7 bar

15 l/m @ 3 bar

G1/8 – 320 l/m @ 7 bar

50 l/m @ 3 bar

**Dimensions:**

M5- 23mm L x 6.5mm W x 21mm H

G1/8- 31.5mm L x 14mm W x 32mm H



Inlet



Exhaust

### Barbed Fittings with One Way Adjustable Flow Controls



For Inlet Ports:

**47071** - 5x1mm tubing, M5 thread

**47081** - 6x1mm tubing, M5 thread

**47086** - 6x1mm tubing, G1/8 thread

For Exhaust Ports:

**47070** - 5x1mm tubing, M5 thread

**47080** - 6x1mm tubing, M5 thread

**47085** - 6x1mm tubing, G1/8 thread

For direct mounting on valve or cylinder ports, with captive adjusting screw and L-banjo type barb fitting.

**Flow Full Open:**

M5 - 3.35 CFM @ 100 PSI

1.4 CFM @ 45 PSI

G1/8 - 3.1 CFM @ 100 PSI

1.3 CFM @ 45 PSI

**Dimensions:**

M5- 18.5mm H x 6.5mm W x 21mm H

G1/8- 21mm H x 14.5mm W x 32mm H



Inlet



Exhaust

### Accessories for Flow Controls

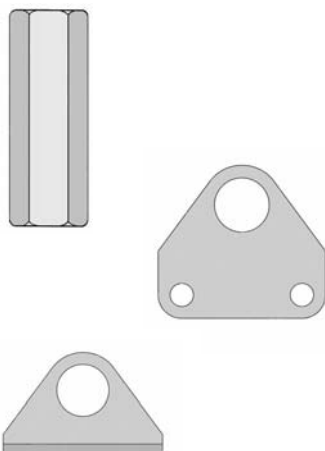

**47266** Protective Cover

Brass cover can be used to cap off adjustable flow controls, preventing tampering after adjustment is set.

**Dimensions:** 30mm H x 10mmHex.

**38305** Flat Mounting Bracket

**38306** L Shaped Mounting Bracket

Used to mount flow controls. Made from zinc plated sheet steel. Mounting holes are 3.5mm dia. on 18mm centers. "L" Bracket has a 9.5mm return flange.

**Dimensions:**

Flat – 23mm H x 25mm W.

L shape – 16mm H. x 25mm W  
x 9.5mm D